

Body side

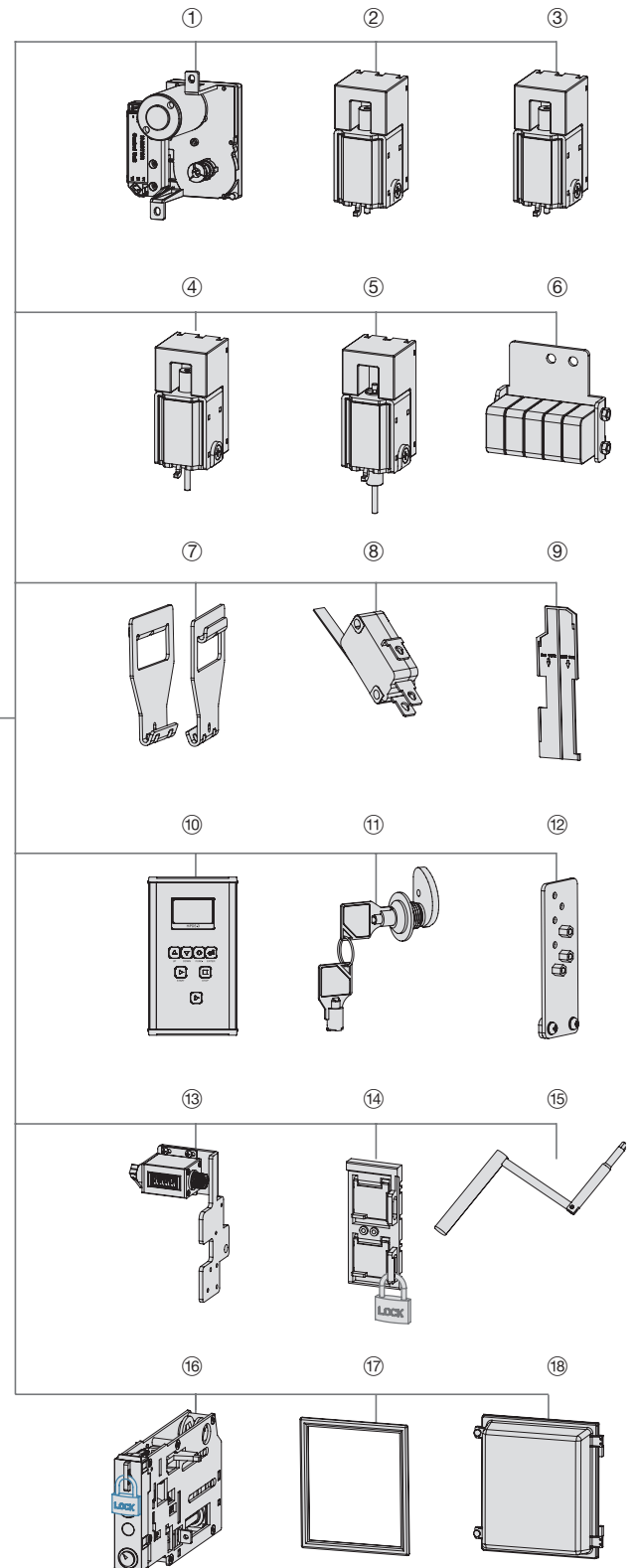

- | | | |
|---------------------------|-----------------------------|-------------------------|
| ① Motor operator | ⑦ Lifting lug | ⑬ Counter |
| ② Closing coil | ⑧ Ready to close | ⑭ ON/OFF button cover |
| ③ Shunt trip coil | ⑨ Phase insulation barrier | ⑮ Draw-in/out handle |
| ④ Second shunt trip coil | ⑩ OCR portable checker | ⑯ Draw-in/out mechanism |
| ⑤ Under voltage trip coil | ⑪ Key lock device | ⑰ Door flange |
| ⑥ Auxiliary switch | ⑫ Wrong insertion preventer | ⑱ Dust cover |



HWAN416ED

Air Circuit Breakers, Frame A

Characteristics

I_{cu}=I_{cs}=50KA
I_{cu}=I_{cs}=I_{cw}

| Description | Rating (A) | Nr. of poles | Cat.Ref | |
|--------------|------------|--------------|---------------|------------|
| | | | draw-out type | fixed type |
| ACB, Frame A | 630 | 3 | HWAH306ED | HWAH306EF |
| ACB, Frame A | 800 | 3 | HWAH308ED | HWAH308EF |
| ACB, Frame A | 1000 | 3 | HWAH310ED | HWAH310EF |
| ACB, Frame A | 1250 | 3 | HWAH312ED | HWAH312EF |
| ACB, Frame A | 1600 | 3 | HWAH316ED | HWAH316EF |
| ACB, Frame A | 2000 | 3 | HWAH320ED | HWAH320EF |
| ACB, Frame A | 630 | 4 | HWAH406ED | HWAH406EF |
| ACB, Frame A | 800 | 4 | HWAH408ED | HWAH408EF |
| ACB, Frame A | 1000 | 4 | HWAH410ED | HWAH410EF |
| ACB, Frame A | 1250 | 4 | HWAH412ED | HWAH412EF |
| ACB, Frame A | 1600 | 4 | HWAH416ED | HWAH416EF |
| ACB, Frame A | 2000 | 4 | HWAH420ED | HWAH420EF |

Air Circuit Breakers, Frame A

Characteristics

I_{cu}=I_{cs}=65KA
I_{cu}=I_{cs}=I_{cw}

| Description | Rating (A) | Nr. of poles | Cat.Ref | |
|--------------|------------|--------------|---------------|------------|
| | | | draw-out type | fixed type |
| ACB, Frame A | 630 | 3 | HWAN306ED | HWAN306EF |
| ACB, Frame A | 800 | 3 | HWAN308ED | HWAN308EF |
| ACB, Frame A | 1000 | 3 | HWAN310ED | HWAN310EF |
| ACB, Frame A | 1250 | 3 | HWAN312ED | HWAN312EF |
| ACB, Frame A | 1600 | 3 | HWAN316ED | HWAN316EF |
| ACB, Frame A | 2000 | 3 | HWAN320ED | HWAN320EF |
| ACB, Frame A | 630 | 4 | HWAN406ED | HWAN406EF |
| ACB, Frame A | 800 | 4 | HWAN408ED | HWAN408EF |
| ACB, Frame A | 1000 | 4 | HWAN410ED | HWAN410EF |
| ACB, Frame A | 1250 | 4 | HWAN412ED | HWAN412EF |
| ACB, Frame A | 1600 | 4 | HWAN416ED | HWAN416EF |
| ACB, Frame A | 2000 | 4 | HWAN420ED | HWAN420EF |



HWBN416ED

Air Circuit Breakers, Frame B

Characteristics

I_{cu}=I_{cs}=65KA
I_{cu}=I_{cs}=I_{cw}

| Description | Rating (A) | Nr. of poles | Cat.Ref | |
|--------------|------------|--------------|---------------|------------|
| | | | draw-out type | fixed type |
| ACB, Frame B | 630 | 3 | HWBN306ED | HWBN306EF |
| ACB, Frame B | 800 | 3 | HWBN308ED | HWBN308EF |
| ACB, Frame B | 1000 | 3 | HWBN310ED | HWBN310EF |
| ACB, Frame B | 1250 | 3 | HWBN312ED | HWBN312EF |
| ACB, Frame B | 1600 | 3 | HWBN316ED | HWBN316EF |
| ACB, Frame B | 2000 | 3 | HWBN320ED | HWBN320EF |
| ACB, Frame B | 2500 | 3 | HWBN325ED | HWBN325EF |
| ACB, Frame B | 3200 | 3 | HWBN332ED | HWBN332EF |
| ACB, Frame B | 4000 | 3 | HWBN340ED | HWBN340EF |
| ACB, Frame B | 630 | 4 | HWBN406ED | HWBN406EF |
| ACB, Frame B | 800 | 4 | HWBN408ED | HWBN408EF |
| ACB, Frame B | 1000 | 4 | HWBN410ED | HWBN410EF |
| ACB, Frame B | 1250 | 4 | HWBN412ED | HWBN412EF |
| ACB, Frame B | 1600 | 4 | HWBN416ED | HWBN416EF |
| ACB, Frame B | 2000 | 4 | HWBN420ED | HWBN420EF |
| ACB, Frame B | 2500 | 4 | HWBN425ED | HWBN425EF |
| ACB, Frame B | 3200 | 4 | HWBN432ED | HWBN432EF |
| ACB, Frame B | 4000 | 4 | HWBN440ED | HWBN440EF |

Air Circuit Breakers, Frame B
Characteristics
 $I_{cu}=I_{cs}=85KA$
 $I_{cu}=I_{cs}=I_{cw}$

| Description | Rating (A) | Nr. of poles | Cat.Ref | |
|--------------|------------|--------------|---------------|------------|
| | | | draw-out type | fixed type |
| ACB, Frame B | 630 | 3 | HWBS306ED | HWBS306EF |
| ACB, Frame B | 800 | 3 | HWBS308ED | HWBS308EF |
| ACB, Frame B | 1000 | 3 | HWBS310ED | HWBS310EF |
| ACB, Frame B | 1250 | 3 | HWBS312ED | HWBS312EF |
| ACB, Frame B | 1600 | 3 | HWBS316ED | HWBS316EF |
| ACB, Frame B | 2000 | 3 | HWBS320ED | HWBS320EF |
| ACB, Frame B | 2500 | 3 | HWBS325ED | HWBS325EF |
| ACB, Frame B | 3200 | 3 | HWBS332ED | HWBS332EF |
| ACB, Frame B | 4000 | 3 | HWBS340ED | HWBS340EF |
| ACB, Frame B | 630 | 4 | HWBS406ED | HWBS406EF |
| ACB, Frame B | 800 | 4 | HWBS408ED | HWBS408EF |
| ACB, Frame B | 1000 | 4 | HWBS410ED | HWBS410EF |
| ACB, Frame B | 1250 | 4 | HWBS412ED | HWBS412EF |
| ACB, Frame B | 1600 | 4 | HWBS416ED | HWBS416EF |
| ACB, Frame B | 2000 | 4 | HWBS420ED | HWBS420EF |
| ACB, Frame B | 2500 | 4 | HWBS425ED | HWBS425EF |
| ACB, Frame B | 3200 | 4 | HWBS432ED | HWBS432EF |
| ACB, Frame B | 4000 | 4 | HWBS440ED | HWBS440EF |



HWBS416ED

Air Circuit Breakers, Frame B
Characteristics
 $I_{cu}=I_{cs}=100KA$
 $I_{cw}=85KA$

| Description | Rating (A) | Nr. of poles | Cat.Ref | |
|--------------|------------|--------------|---------------|------------|
| | | | draw-out type | fixed type |
| ACB, Frame B | 630 | 3 | HWBP306ED | HWBP306EF |
| ACB, Frame B | 800 | 3 | HWBP308ED | HWBP308EF |
| ACB, Frame B | 1000 | 3 | HWBP310ED | HWBP310EF |
| ACB, Frame B | 1250 | 3 | HWBP312ED | HWBP312EF |
| ACB, Frame B | 1600 | 3 | HWBP316ED | HWBP316EF |
| ACB, Frame B | 2000 | 3 | HWBP320ED | HWBP320EF |
| ACB, Frame B | 2500 | 3 | HWBP325ED | HWBP325EF |
| ACB, Frame B | 3200 | 3 | HWBP332ED | HWBP332EF |
| ACB, Frame B | 4000 | 3 | HWBP340ED | HWBP340EF |
| ACB, Frame B | 630 | 4 | HWBP406ED | HWBP406EF |
| ACB, Frame B | 800 | 4 | HWBP408ED | HWBP408EF |
| ACB, Frame B | 1000 | 4 | HWBP410ED | HWBP410EF |
| ACB, Frame B | 1250 | 4 | HWBP412ED | HWBP412EF |
| ACB, Frame B | 1600 | 4 | HWBP416ED | HWBP416EF |
| ACB, Frame B | 2000 | 4 | HWBP420ED | HWBP420EF |
| ACB, Frame B | 2500 | 4 | HWBP425ED | HWBP425EF |
| ACB, Frame B | 3200 | 4 | HWBP432ED | HWBP432EF |
| ACB, Frame B | 4000 | 4 | HWBP440ED | HWBP440EF |

Air Circuit Breakers, Frame C
Characteristics
 $I_{cu}=I_{cs}=100KA$
 $I_{cw}=85KA$

| Description | Rating (A) | Nr. of poles | Cat.Ref | |
|--------------|------------|--------------|---------------|------------|
| | | | draw-out type | fixed type |
| ACB, Frame C | 3200 | 3 | HWCP332ED | HWCP332EF |
| ACB, Frame C | 4000 | 3 | HWCP340ED | HWCP340EF |
| ACB, Frame C | 5000 | 3 | HWCP350ED | HWCP350EF |
| ACB, Frame C | 3200 | 4 | HWCP432ED | HWCP432EF |
| ACB, Frame C | 4000 | 4 | HWCP440ED | HWCP440EF |
| ACB, Frame C | 5000 | 4 | HWCP450ED | HWCP450EF |



HWCP432ED